



Medium-Voltage Epoxy Support Insulators

ESI-101, ESI-201, ESI-202, ESI-301, ESI-302

◆ Introduction

Intended for 12 kV, 24 kV, or 36 kV power systems, these support insulators, also called “post insulators,” are cast in Araldite® epoxy resin. With excellent resistance to moisture, these easy-to-install insulators can be used in locations with salty or polluted air.

◆ Features

- Standard: IEC 60660, or CNS 6796 (C4292)
- Indoor application
- Cast in Araldite® epoxy resin
- Rated Voltage: 12 kV, 24 kV, or 36 kV
- Type-tested according to CNS 6796 (C4292)
- Partial Discharge Level: ≤ 100 pC
- Products can be customized
- ODM and OEM services available



◆ Selection Table

Model	Rated Voltage kV	AC / BIL kV	Creepage mm	Shed Number	Bending Strength 1 min. kgf (N)	Torsional Strength kgf-m	Tensile Strength kgf	Approx. Weight kg
ESI-101	12	36 / 75	165	4	240 (2354)	30	2000	0.5
ESI-201	24	60 / 125	360	9	240 (2354)	30	2000	1.2
ESI-202	25	80 / 150	380	9	240 (2354)	30	2000	1.45
ESI-301	36	80 / 170	520	11	600 (5884)	30	3000	1.9
ESI-302	36	80 / 185	530	11	600 (5884)	30	3000	2.0

CIC CHALLENGE INDUSTRIAL CO., LTD.
SINCE 1974

Headquarters

Tel : +886-2-7883368
Fax : +886-2-7883319

IF, No. 46, Ln. 80, Sec. 3, Nangang Rd., Nangang Dist.,
Taipei City 115, TAIWAN
www.cic-ltd.com.tw



ISO 9001



FLUKE

AMPROBE

◆ CNS 6796 (C4292) Type Test Reports



◆ Product Dimensions

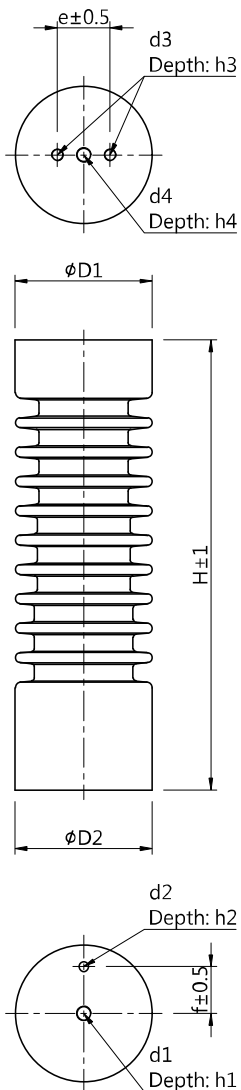

Model	Rated Voltage (kV)	H	e	f	$\phi D1$	$\phi D2$
		(mm)				
ESI-101	12	130	36	21	56	56
ESI-201	24	210	36	24	70	70
ESI-202	25	230	36	24	70	70
ESI-301	36	300	36	24	80	80
ESI-302	36	310	36	24	80	80

Model	d1	d2	d3	d4	h1	h2	h3	h4
	(mm)							
ESI-101	M10	M5	M8	M10	25	10	15	25
ESI-201				-				-
ESI-202	-		-	-				
ESI-301	M16	M16	M10	30	8	20		
ESI-302								